

湛江市赤坎区白云路新建工程征收(回收)范围图  
2355.95-434.50

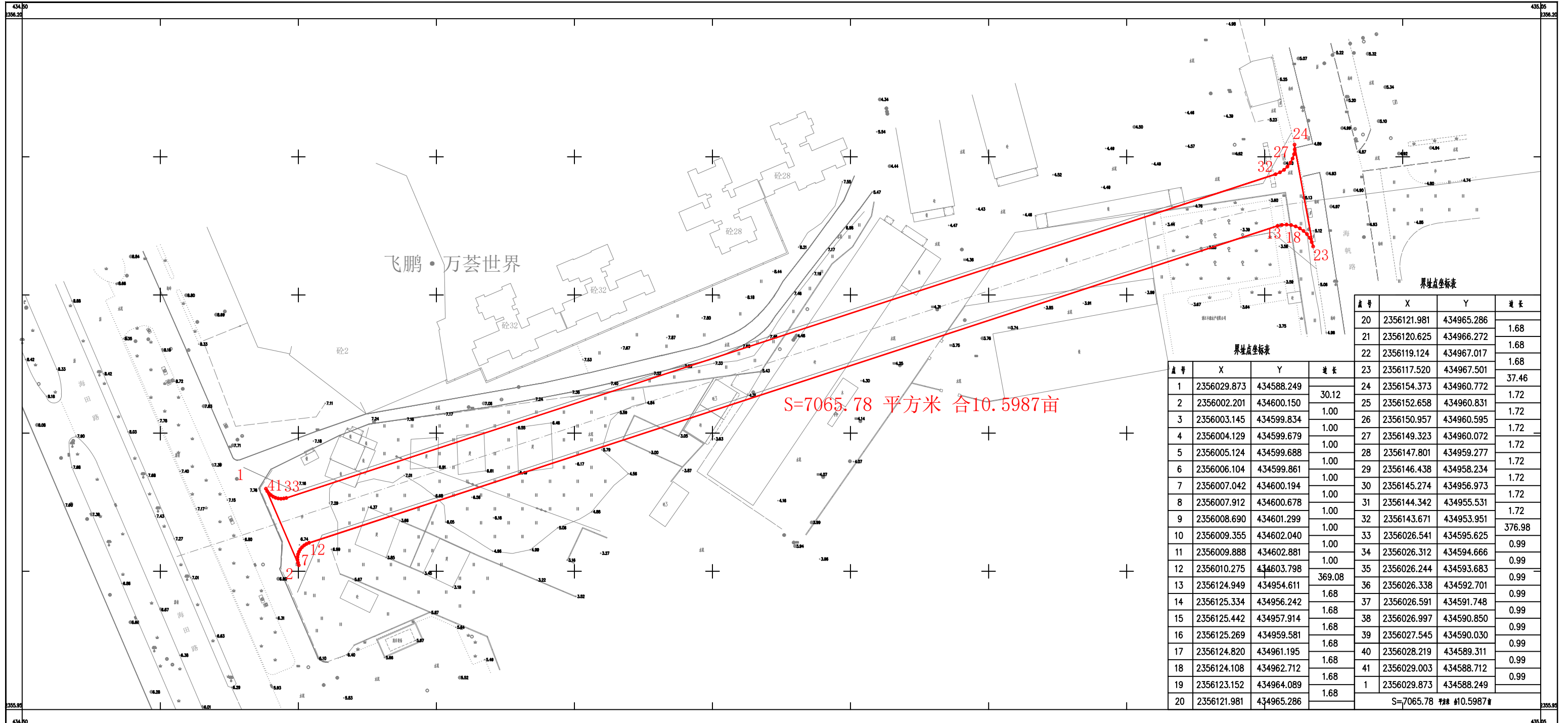

S=7065.78 平方米 合10.5987亩

界址点坐标表			
点号	X	Y	边长
20	2356121.981	434965.286	
21	2356120.625	434966.272	1.68
22	2356119.124	434967.017	1.68
23	2356117.520	434967.501	1.68
24	2356154.373	434960.772	37.46
1	2356029.873	434588.249	1.72
2	2356002.201	434600.150	1.00
3	2356003.145	434599.834	1.00
4	2356004.129	434599.679	1.00
5	2356005.124	434599.688	1.00
6	2356006.104	434599.861	1.00
7	2356007.042	434600.194	1.00
8	2356007.912	434600.678	1.00
9	2356008.690	434601.299	1.00
10	2356009.355	434602.040	1.00
11	2356009.888	434602.881	1.00
12	2356010.275	434603.798	1.00
13	2356124.949	434954.611	369.08
14	2356125.334	434956.242	1.68
15	2356125.442	434957.914	1.68
16	2356125.269	434959.581	1.68
17	2356124.820	434961.195	1.68
18	2356124.108	434962.712	1.68
19	2356123.152	434964.089	1.68
20	2356121.981	434965.286	1.68
25	2356152.658	434960.831	1.72
26	2356150.957	434960.595	1.72
27	2356149.323	434960.072	1.72
28	2356147.801	434959.277	1.72
29	2356146.438	434958.234	1.72
30	2356145.274	434956.973	1.72
31	2356144.342	434955.531	1.72
32	2356143.671	434953.951	1.72
33	2356026.541	434595.625	376.98
34	2356026.312	434594.666	0.99
35	2356026.244	434593.683	0.99
36	2356026.338	434592.701	0.99
37	2356026.591	434591.748	0.99
38	2356026.997	434590.850	0.99
39	2356027.545	434590.030	0.99
40	2356028.219	434589.311	0.99
41	2356029.003	434588.712	0.99
1	2356029.873	434588.249	0.99
S=7065.78 平方米 合10.5987亩			

2020年5月竣工日期  
2000国家大地坐标系  
1:985 数字高程模型  
GB/T20257.1-2017 数字城市地理信息数据库